

Project 1

Design Enrichment

2023

Sarah Levin
991526576

Bachelors of Interior
Design

Advanced Studio 2 |
DESN 46859

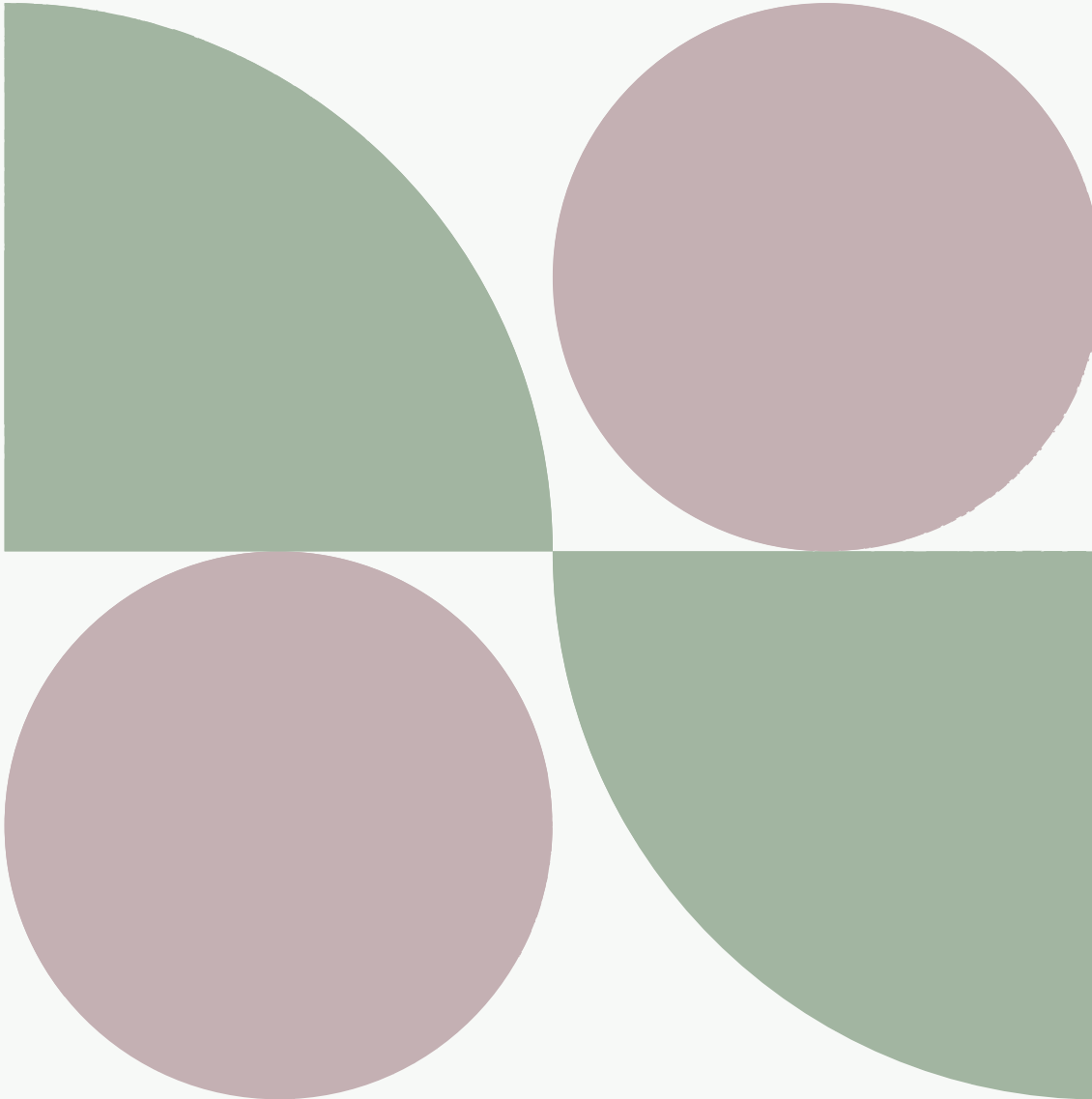

PREPARED FOR LEAH SHERWOOD
JANUARY 25TH, 2023

Post Secondary Success Centre Mission Statement/Intro



The Post Secondary Success Centre (PSSC) is a program facility that provides academic aid inclusive of all economic backgrounds. The centre creates a foundation for those who feel lost in their academic journeys. The space was designed to uphold any students preferred learning environment through the wide range of secluded and communal work spaces. I emphasized nature and fluidity in the facilities design to promote productivity in a stress free environment. The centre is organized by dividing quadrants dedicated to incorporating views of nature, acoustic panels for privacy, adjustable artificial natural daylight sensors and music pods to destress between breaks. The space will approach the balance between natural form and up to date technology to provide a harmonious combination in creating a unique customizable tutoring experience.

Post Secondary Success Centre Floor Plan

BEFORE

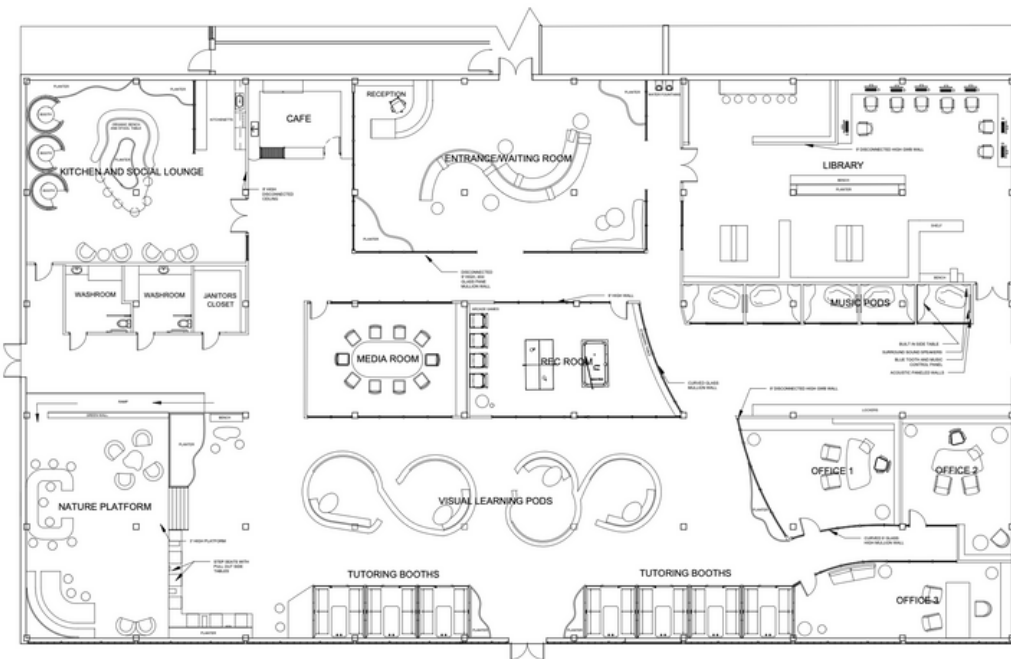

AFTER

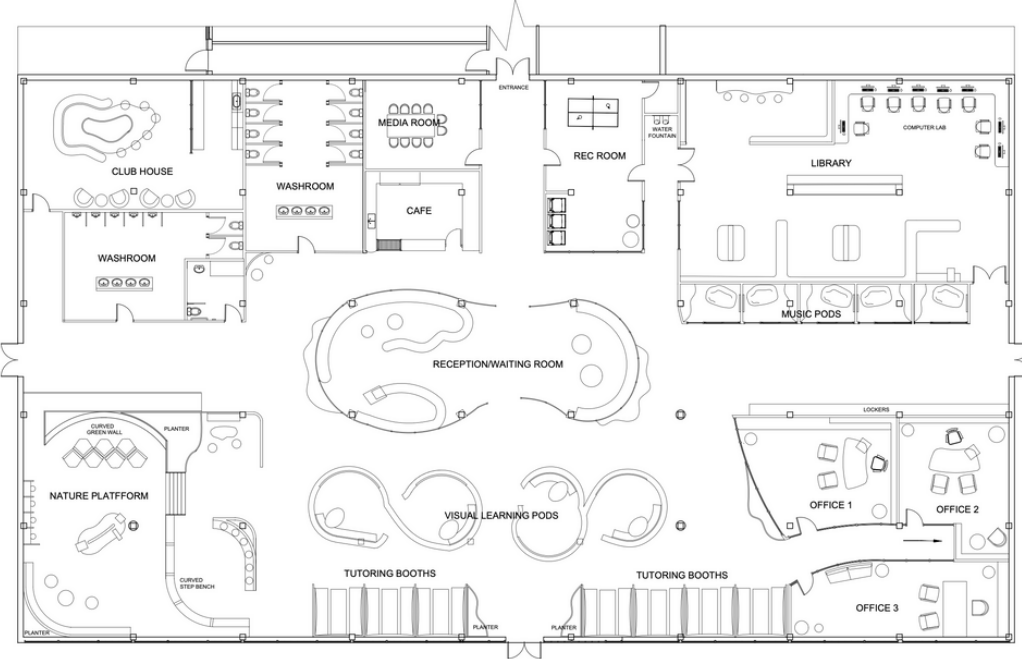

TASK 1: BEFORE

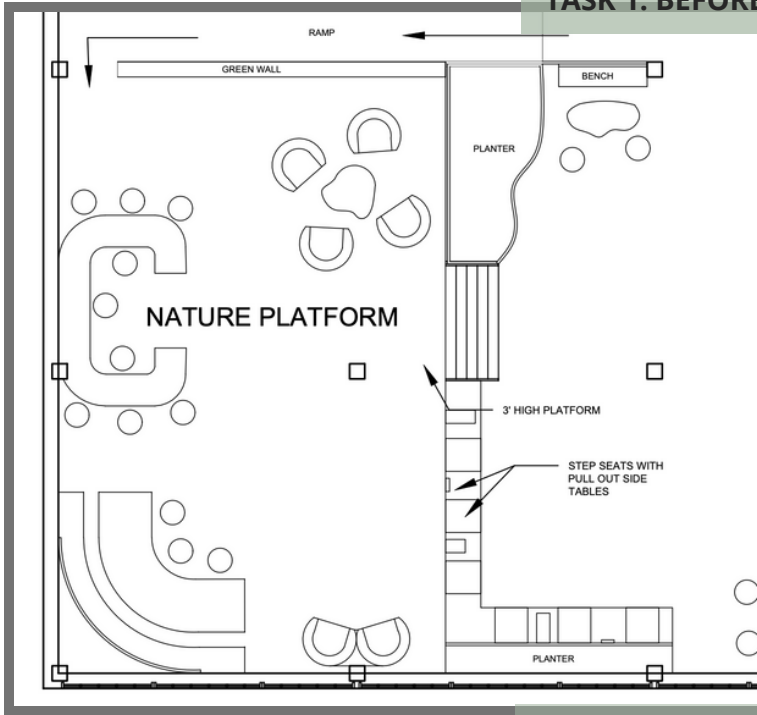

TASK 1: AFTER

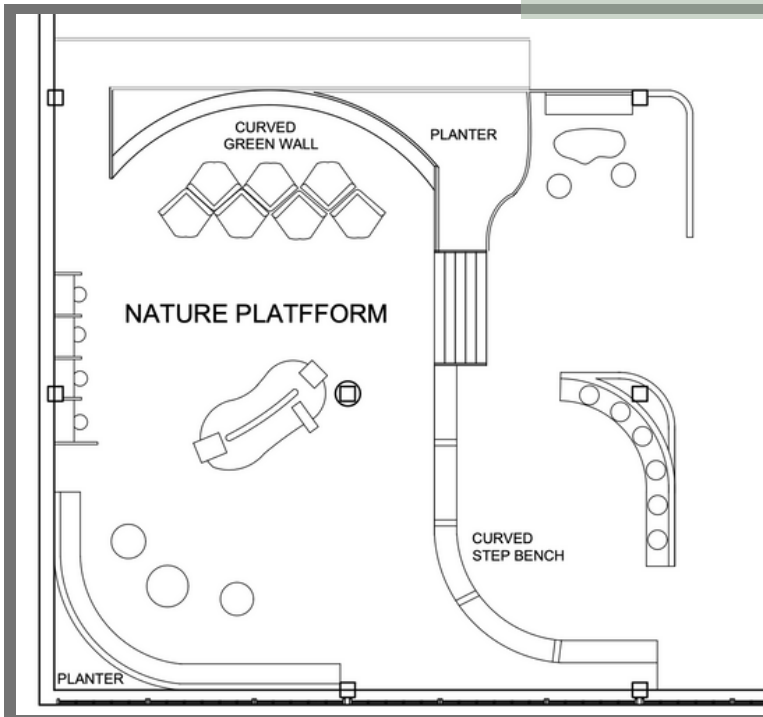

TASK 1: REVISED PLAN

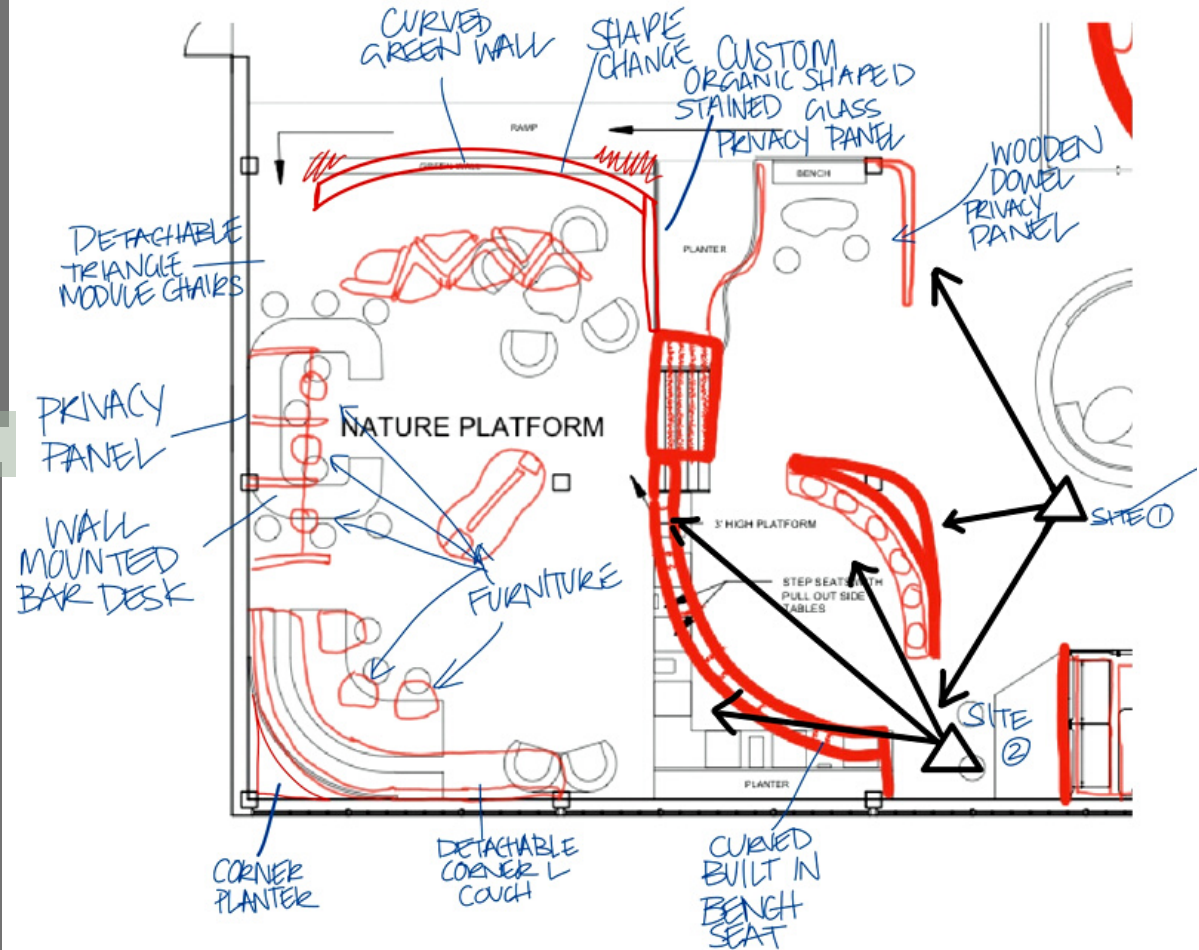

TASK 1: NATURE PLATFORM VS. CENTRAL TUTORING STATIONS

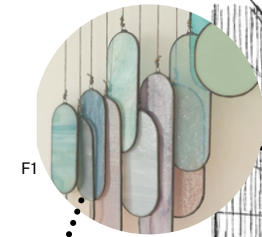

F1

Lumi Glass: custom stained glass ceiling pedant

Planter

Stained glass space divider

Custom malleable acrylic
white board with brass bolts

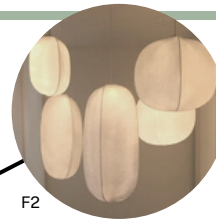

F2

Curved green wall composed of tubular steel frame, plastic panel, woven fabric, water nutrient and felt

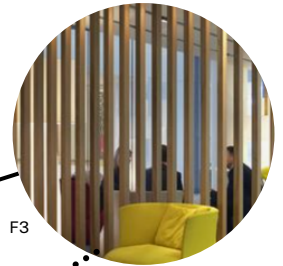

F3

Wooden panel
spacial divider

Arc Acoustic
Panels by Studio
Stone custom fit in
an semi circle
shape

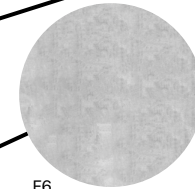

F6

Concrete Floor:
existing
Matte Finish

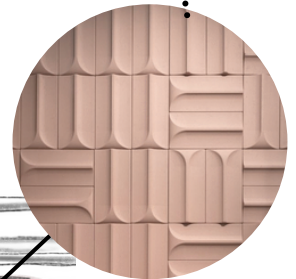

F7

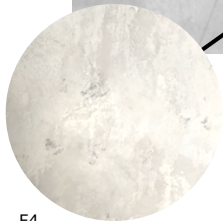

F4

Dry Wall curved wall,
plywood cast with an
Eggshell matte plaster finish:



F5

• Wooden slats statement wall



F8

matte wood
veneer over
curved plywood
and mdf

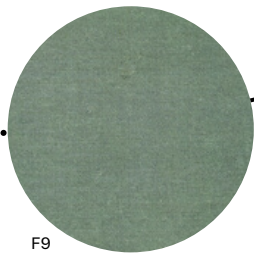

F9

Purehopsack Drapery,
Upholstery, Panel Pure
California Collection,
Durability 100,000 double
rubs;Stain Resistant

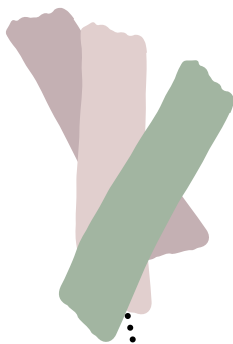

**"Color Palettes To Help Heal
F10 ADHD and Depression"**
(Donna Frasca, Intuitive Color
Expert)

TASK 2 : BEFORE

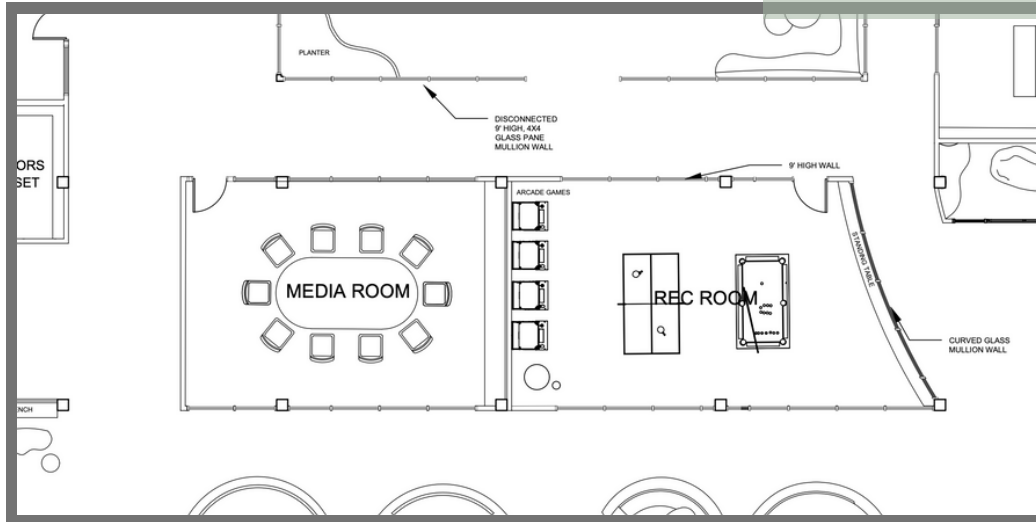

TASK 2: AFTER

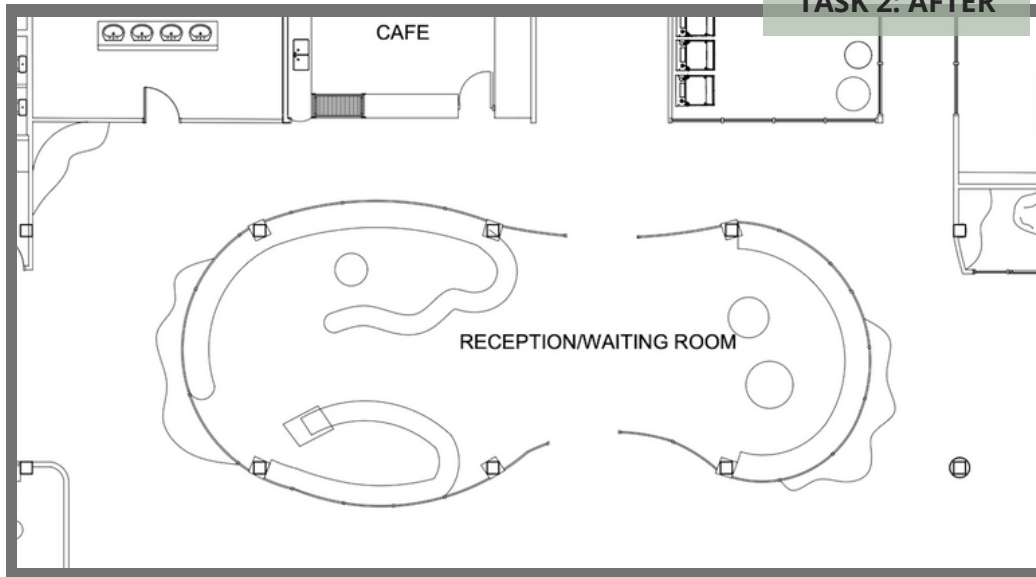

TASK 2: REVISED PLAN

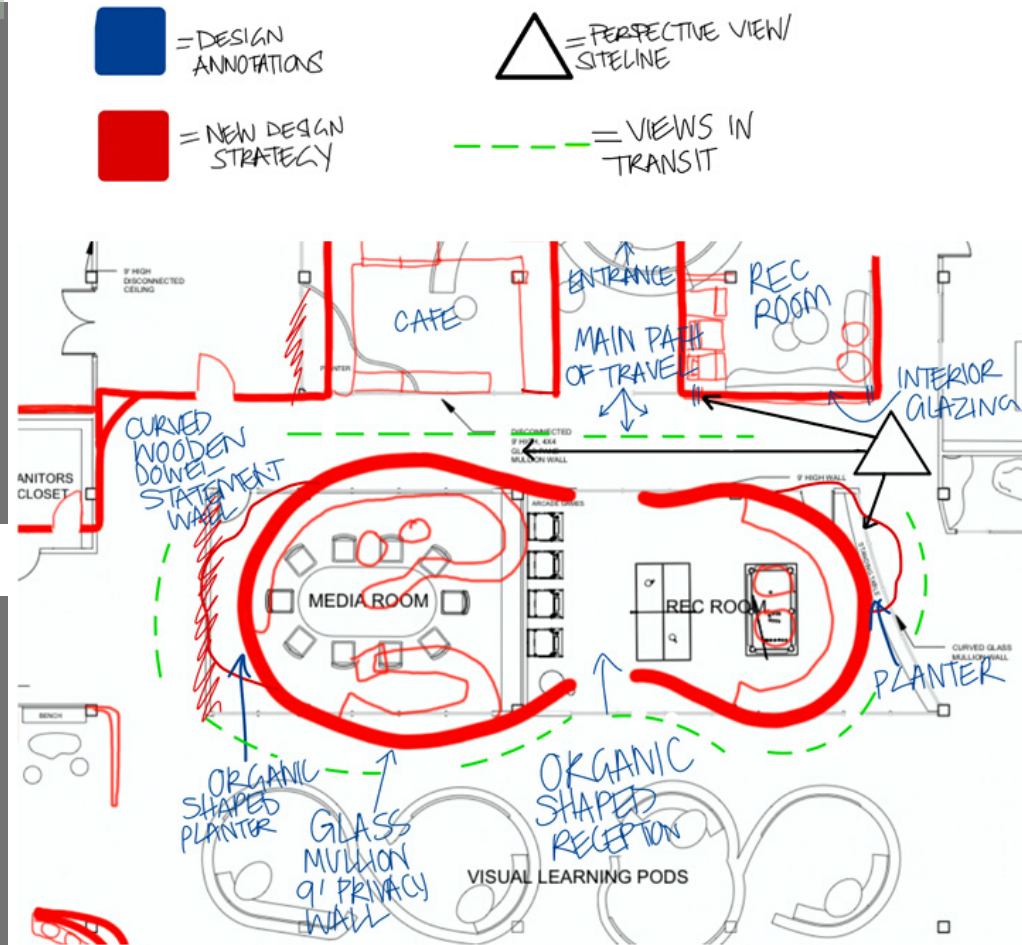

TASK 2: VIEW OF NORTH HALLWAY

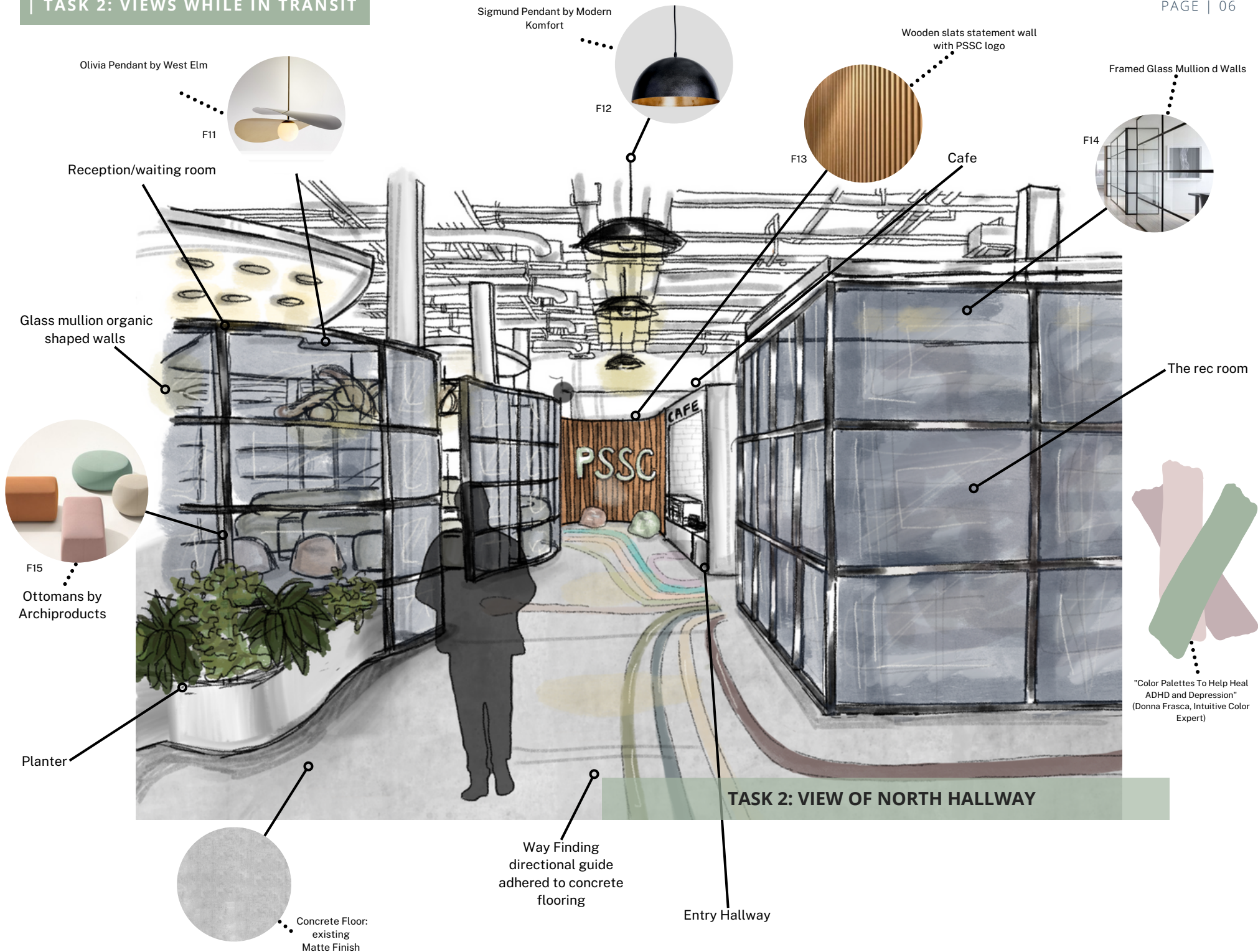

TASK 2: VIEW OF NORTH HALLWAY

TASK 3: BEFORE

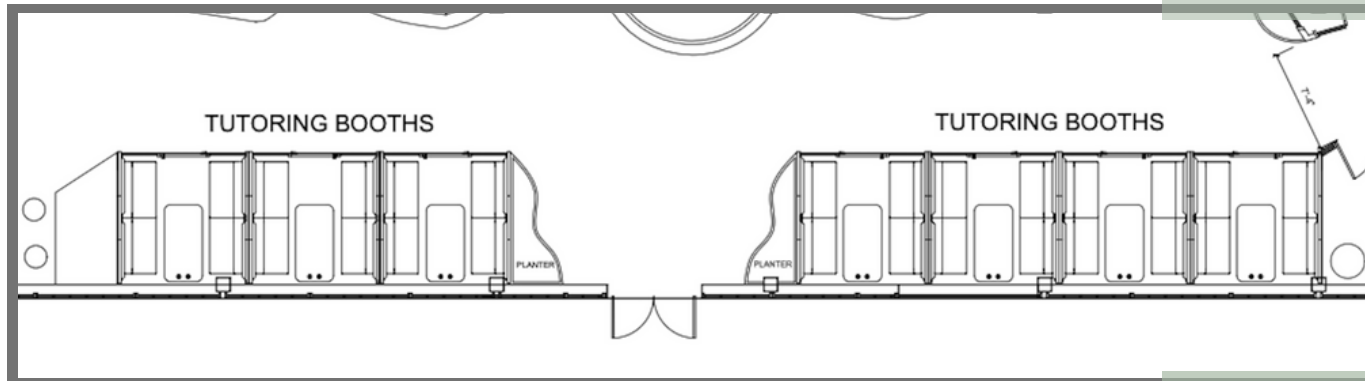

TASK 3 : AFTER

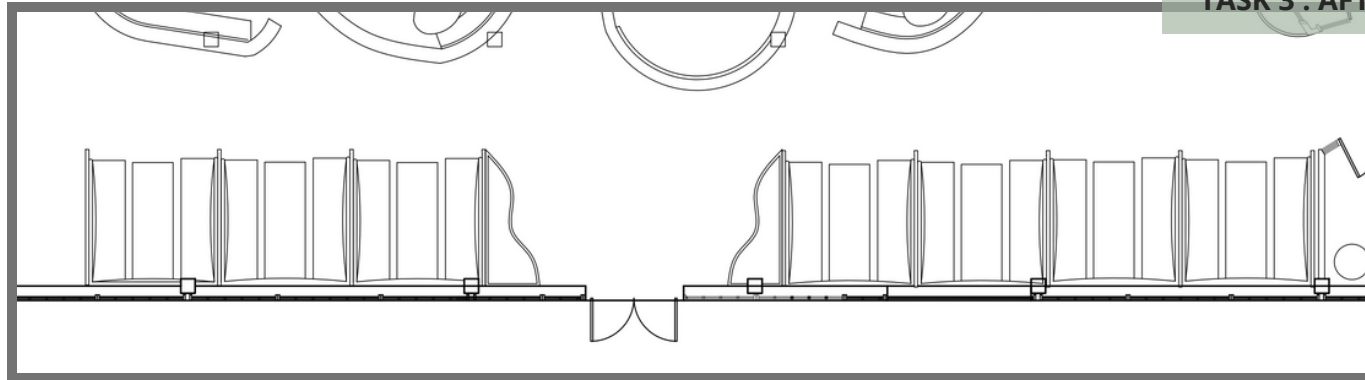

= DESIGN ANNOTATIONS

= PERSPECTIVE VIEW/ SITELINE

= NEW DESIGN STRATEGY

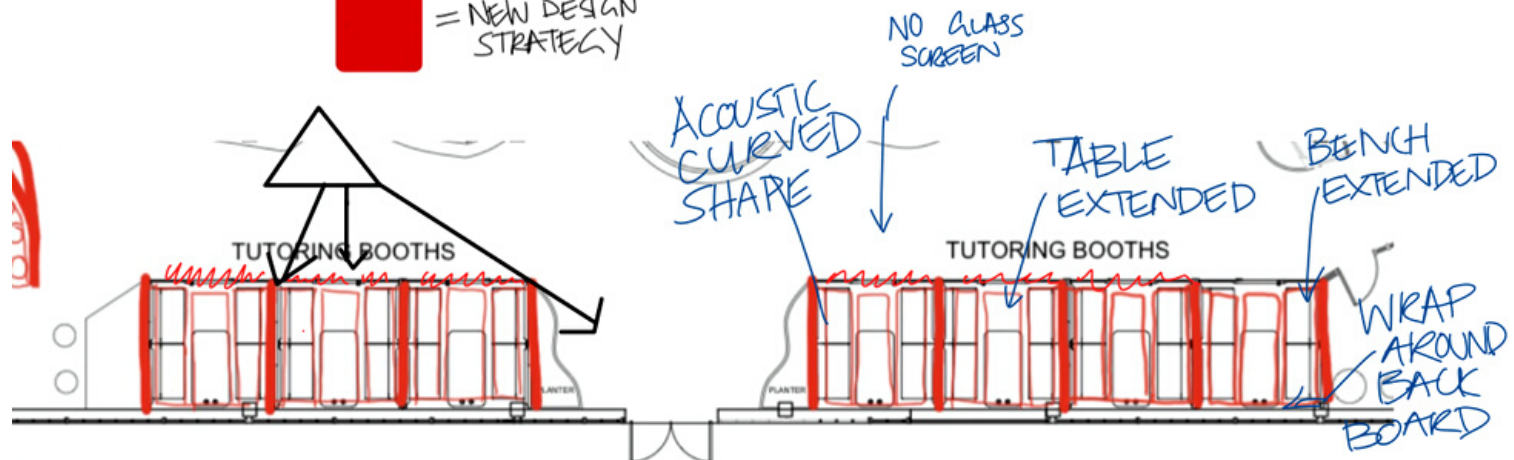

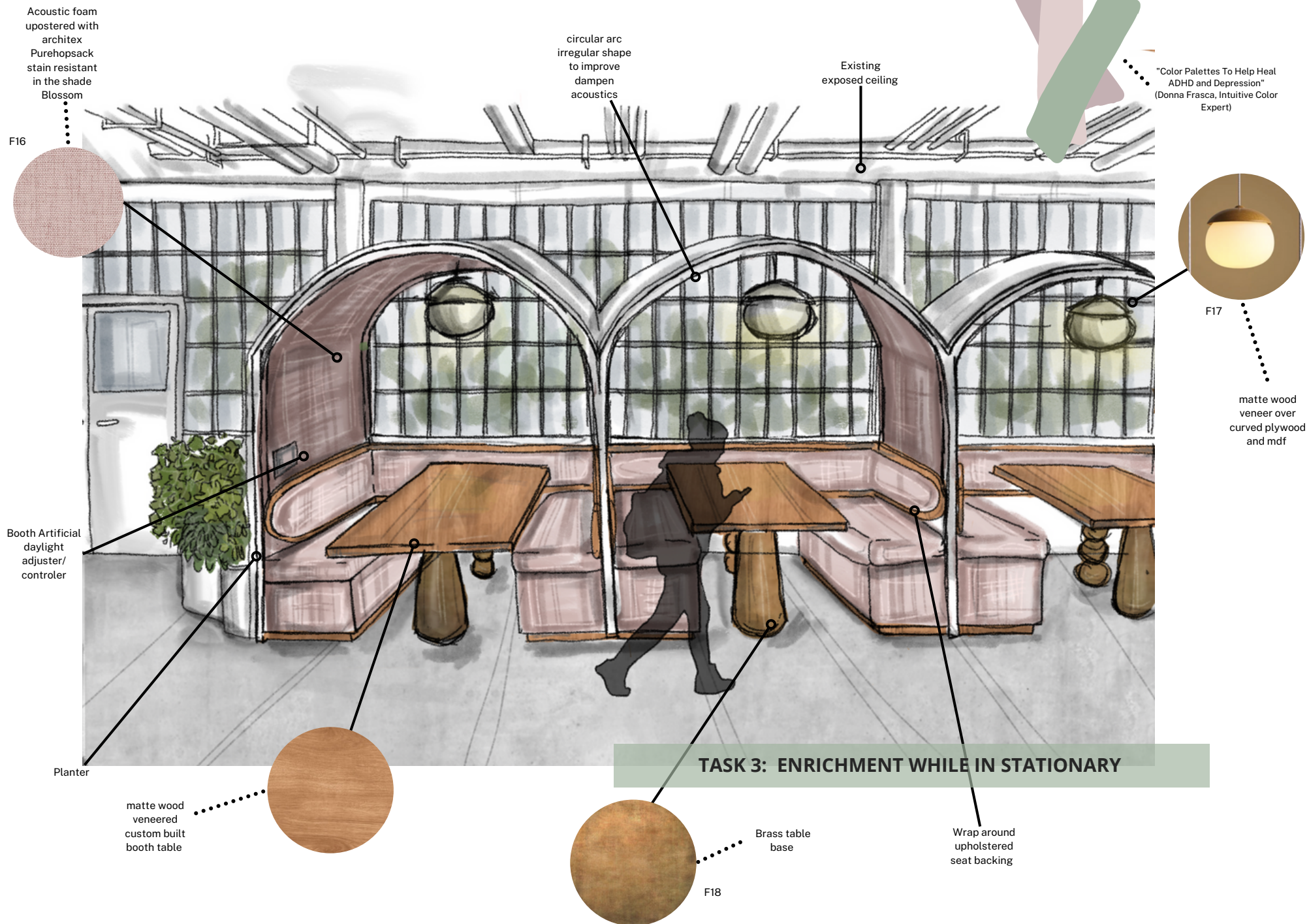

Written Response

The design of the PSSC prioritizes inclusivity and opportunities for social interaction. A variety of designated spaces with contrasting social settings have been included to accommodate different needs and preferences. The Nature Platform is designed to provide a peaceful and quiet environment for independent study, while also offering different levels of privacy through various seating options. In contrast, the Rec Room and Social Lounge encourage social interaction through limited seating and collaborative seating arrangements. All seating areas in the PSSC are wheelchair accessible, including the Nature Platform, which features a ramp for easy access.

The PSSC's color palette, featuring neutral shades of pink and green, has been carefully chosen to create a calming and healing environment. Research by color expert Donna Frasca suggests that this color palette can help alleviate symptoms of ADHD and depression. Our goal is to create a unique and meaningful experience that reduces anxiety for all users. The PSSC's spaces have been enriched through the use of unique acoustic paneling, glass mullion walls, and innovative technology to enhance the user experience. Overall, the PSSC is designed to create a sense of belonging and support students during the often stressful post-secondary journey.

SOURCES

F1: <https://i.pinimg.com/originals/d7/2c/a2/d72ca284dcdc1795e7c4259167c60e97.jpg>

F2: https://richbrilliantwilling.com/collections/mori?utm_source=pinterest&utm_medium=social

F3: <https://i.pinimg.com/564x/6e/07/d0/6e07d0e8e27ba9590f3c0b93635f215f.jpg>

F4: Adobe Stock Images

F5: <https://www.workshopapd.com/projects/residential/view/sagaponack-modern/?>

epik=dj0yJnU9RDF5RGZJYlRmYWV3RVZFckN3THFCZUpaTlVTWm1CYzAmcD0wJm49c0ZPc0tkVy03V2Q00TN2cTlzZWtJQSZ0PUFBQUFBR1BSMjBr

F6: Adobe Stock Images

F7: <https://www.blastation.com/products/product-families/arc/arc>

F8: Adobe Stock Images

F9: Adobe Stock Images

F10: <https://decoratingbydonna.com/2016/01/11/color-palettes-to-help-heal-adhd-and-depression/>

F11: <https://www.westelm.ca/products/olivia-pendant-w4001/?>

catalogId=71&sku=9915541&cm_ven=PLA&cm_cat=Google&cm_pla=Lighting%20%3E%20Pendants&cm_ite=9915541_13539753036&gclid=Cj0KCQiA_bieBhDSARIsADU4zLdd_PfntrPuLDyAD9rh0fpYjd7krd3r37gvFSZcuQ51gnvK7bo6lcsaAn5aEALw_wcB

F12: <https://modernkomfort.ca/products/sigmund-pendant-small-black?>

variant=39262853201955&gclid=Cj0KCQiAw8OeBhCeARIsAGxWtUya3r6c8IGPdHaNxakXlF_rc1UuWxAW-WKdAeFlK-nUFYSMoBx-7voaAvFOEALw_wcB

F13: <https://i.pinimg.com/564x/6e/07/d0/6e07d0e8e27ba9590f3c0b93635f215f.jpg>

F14: <https://houseofgracedesign.wordpress.com/2016/12/01/maison-grace-the-house-of-grace-office-goals/>

F15: https://www.archiproducts.com/en/news/arper-s-human-centric-designs_70439?

epik=dj0yJnU9OFJiREdLR3liQVF5eE5pODRwN2huTkdBaktCbUtrNEUmcD0wJm49UEpfMVg3SmVxNWpXR09SZTVPaHUzQSZ0PUFBQUFBR1BSM0lV

F16: <https://www.architex-ljh.com/purehopsack-blossom/>

F17: <https://monenseignelumineuse.fr/en/products/suspension-vintage-eclairage-interieur-bois-grain-verre-fer-painder-pendentif-lampe-suspension?variant=39319482990748>

F18: Adobe Stock Images